

Demonstration of push wire connectors for building installation

Application of push-in connectors:

- 1、Electrical connection in all kinds of the lighting decoration.
- 2、Wire conversion and distribution in the junction box.
- 3、Electrical connection for the home appliances.
- 4、Connect way for all small power fixed appliances.

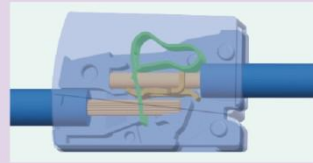

Operation instruction:

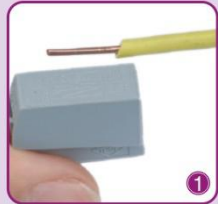

Wire stripping:
Strip the wire sheath according to stripping length.

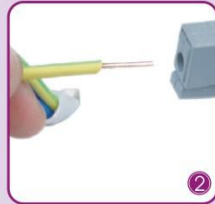

Wire connection at electric supplying side:
Put the stripped solid wire entirely into the rounded hole of the connector.



Wire connection at electric using side:
Press the moving part of the quadrate hole, push the wire to the bottom and then leave it.

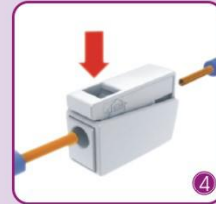

Connection test:
The product has the testing hole, can be easily tested.

The feature of the push wire connector:

- 1、Security: Avoid wire loosening, tape aging etc.
- 2、Convenient: Can insert the wire directly after stripping. It's reusable.
- 3、Reliable: Every contact is independent and firm combination and safe connection.
- 4、Practical: There is the specific hole for the testing.

Operation instruction:

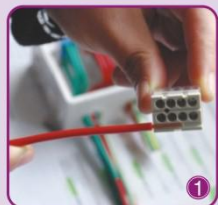

Wire stripping:
Strip the wire sheath according to stripping length.

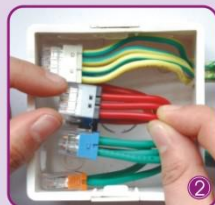

wire connection:
Insert the stripped wire entirely into the hole of the connector.



wire release:
Rotate the solid wire left and right slowly, and meanwhile pull it out, can release the wire.



Connection test:
The product has the testing hole, can make the circuit easily tested

08

Pushwire connection for building installation

The push wire connector apply the spring cage and slide spring technology, It will be more convenient and secure and reliable in the building installation. It's widely used in the field such as lighting, kitchen utensils, small power household appliances. The products meet the international standard IEC60998, UL1059 etc., in accordance with CQC, UL, VDE, TUV, CE, ROHS.

520 push-in connection terminal block	71
520 push-in connection terminal block (electric supplying side can connect 2 wires)	71
520 push-in connection terminal block (middle connector)	71
522 connector for junction box	71
522 3-Way push wire connector	72
525 male / female connector	72
525 male / female connector module	72

Pushwire connection for building installation



520 push-in connection terminal block



Rated voltage/Rated current/Cross-section						Size [mm]	Color	Order No.	Pack.-unit pcs
IEC			UL						
Voltage [V]	Current [A]	Cross-section [mm ²]	Voltage [V]	Current [A]	Cross-section [AWG]				
400	24	1.0-2.5	600	20	20-16	8.5x20.5x15.5	Gray	520101	100

520 push-in connection terminal block (electric supplying side can connect 2 wires)



Rated voltage/Rated current/Cross-section						Size [mm]	Color	Order No.	Pack.-unit pcs
IEC			UL						
Voltage [V]	Current [A]	Cross-section [mm ²]	Voltage [V]	Current [A]	Cross-section [AWG]				
400	24	1.0-2.5	600	20	20-16	9.5x20.5x15.5	White gray	520112	100

520 push-in connection terminal block (middle connector)



Rated voltage/Rated current/Cross-section						Size [mm]	Color	Order No.	Pack.-unit pcs
IEC			UL						
Voltage [V]	Current [A]	Cross-section [mm ²]	Voltage [V]	Current [A]	Cross-section [AWG]				
400	24	1.0-2.5	600	20	20-16	8.5x42x15.5	Gray	520201	50

522 connector for junction box

2 way push wire connector



4 way push wire connector



6 way push wire connector



8 way push wire connector



Poles No.	Rated voltage/Rated current/Cross-section						Size [mm]	Color	Order No.	Pack.-unit pcs
	IEC			UL						
	Voltage [V]	Current [A]	Cross-section [mm ²]	Voltage [V]	Current [A]	Cross-section [AWG]				
2-conductor	400	24	0.75-2.5	600	20	16-14	18.6x8.2x15.7	Orange	522402	100
4-conductor	400	24	0.75-2.5	600	20	16-14	18.6x12.2x15.7	Blue	522404	100
6-conductor	400	24	0.75-2.5	600	20	16-14	18.6x16.2x15.7	Black	522406	50
8-conductor	400	24	0.75-2.5	600	20	16-14	18.6x20.5x15.7	White gray	522408	50

Pushwire connection for building installation



522 3-Way push wire connector



Poles No.	Rated voltage/Rated current/Cross-section			Size [mm]	Color	Order No.	Pack.-unit pcs
	IEC						
	Voltage [V]	Current [A]	Cross-section [mm ²]				
3-conductor	400	41	1.5-4.0	20.1x25.1x13.1	Gray	522303	50

525 male / female connector

SP525 female connector



SP525 male connector



L = (poles No.-1)x10mm+8.5mm

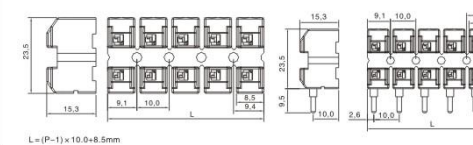

Poles No.	Rated voltage/Rated current/Cross-section			Order No.	
	Voltage [V]	Current [A]	Cross-section [mm ²]	Female	Male
2	400	16	0.5-2.5	525202	525402
3	400	16	0.5-2.5	525203	525403
...
11	400	16	0.5-2.5	525211	525411
12	400	16	0.5-2.5	525212	525412

525 male / female connector module



Poles No.	Rated voltage/Rated current/Cross-section			Order No.
	IEC			
	Voltage [V]	Current [A]	Cross-section [mm ²]	
2	400	16	0.5-2.5	525802
3	400	16	0.5-2.5	525803
4	400	16	0.5-2.5	525804
5	400	16	0.5-2.5	525805